

Installation Guide

Outside Mount

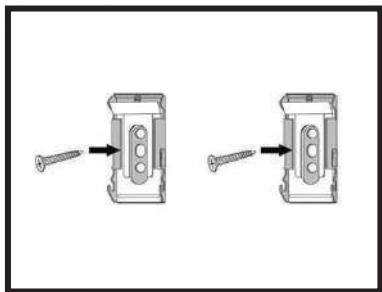

1. Install the two brackets on the wall with screws provided.

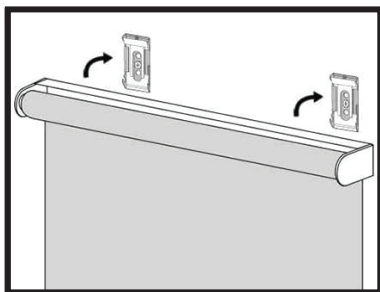

2. Hook the rail onto the front of the bracket and rotate it until the back of the rail securely snaps into place.

Inside Mount

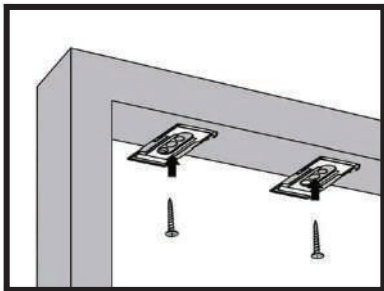

1. Install the brackets on the ceiling with screws provided.

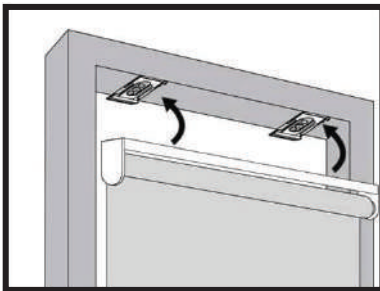

2. Hook the rail onto the bottom of the bracket and rotate it until the back of the rail securely snaps into place.